



Liverpool Road, London, E10

BUTLER & STAG



Open Day Saturday The 13th March - By Appointment Only.
A beautifully presented and well-proportioned Victorian three bedroom family home.



Freehold

- Victorian Mid Terraced Family Home
- Three Bedrooms
- Spacious Lounge/Dining Room
- Potential To Extend (sspp)
- Walking Distance To Walthamstow Village

This lovely family home offers a spacious reception room with large bay windows, a kitchen/dining area, ideal for those who enjoy entertaining, with the added bonus of a conservatory.

On the first floor, you are welcomed by two spacious bedrooms, a third single bedroom and a family bathroom.

Liverpool Road is an enviable and quiet location. It is within easy reach of Walthamstow Village and the good transport links of the Lea Bridge Road. It's the perfect location for easy access to both Walthamstow Central on the Victoria Line and Leytonstone on the Central Line, and roads like the A406, and the A12. Just a few minutes away is the beautiful Epping Forest and the famous Hollow Pond, a wonderful location for running, walking or simply enjoying the scenery and having a picnic.





Liverpool Road,

Ground Floor

Approx. 56.48 Sq. meters (608 Sq. feet)

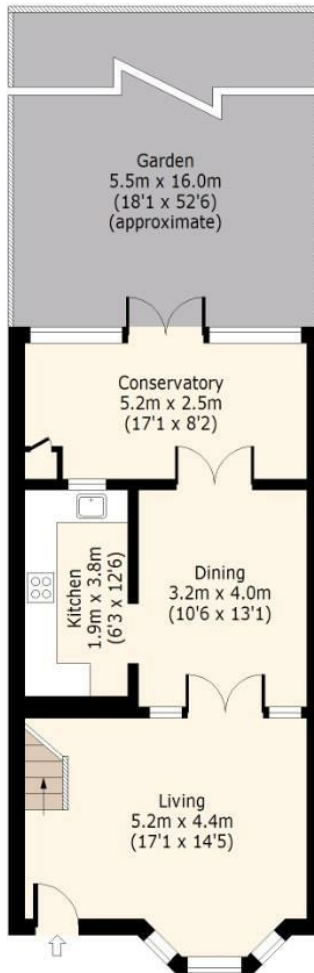

First Floor

Approx. 43.48 Sq. meters (468 Sq. feet)

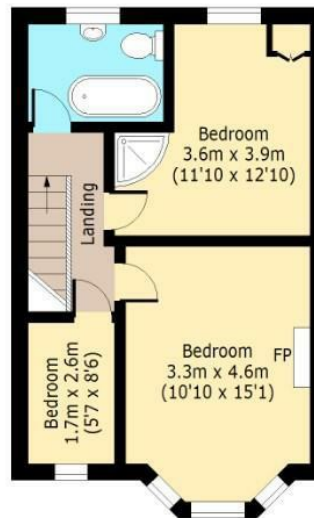

Total area: approx. 99.96 Sq. meters (1076 Sq. feet)
For illustration purposes only - not to scale
www.lpaplus.com

IMPORTANT NOTICE - These particulars have been prepared in good faith and they are not intended to constitute part of an offer or contract. We have not performed a structural survey on this property and the services, appliances an specific fittings have not been tested. All photographs, measurements, floor plans and distances referred to are given as a guide and should not be relied upon.

BUTLER & STAG

☎ 01992 667666

🏠 4 Forest Drive, Theydon Bois, Essex, CM16 7EY

✉ theydon@butlerandstag.com

www.butlerandstag.uk